

# ■Voltage Doubler/Bridge Rectifier Automatic Switch ICs

Part No.	Absolute Maximum Ratings (T <sub>a</sub> =25°C)					Electrical Characteristics (T <sub>a</sub> =25°C)					Remarks
	Repetitive Peak Off-state Voltage	RMS On-state Current	Surge On-state Current	Operating Temperature	Storage Temperature	Voltage Doubler Function Turn-on Voltage	Setting Switchover Voltage		OFF-state Current	ON-state Voltage	
							V <sub>C1</sub> (V)	V <sub>C2</sub> (V <sub>AC</sub> )*			
STR80145A	500	5.0	50	-10 to +100(T <sub>C</sub> )	-30 to +125	AC80 max	196±5	145	100 max	1.8 max	
81145A		10.0	100				215±5	159			
81159A											
STR82145	500	5.0	50	-20 to +100(T <sub>C</sub> )	-40 to +125	DC100 max	205±5	145	100 max	1.8 max	With latching capability
83145		10.0	100				225±5	159			
83159											

\*Reference value

## ■External Dimensions

(unit: mm)

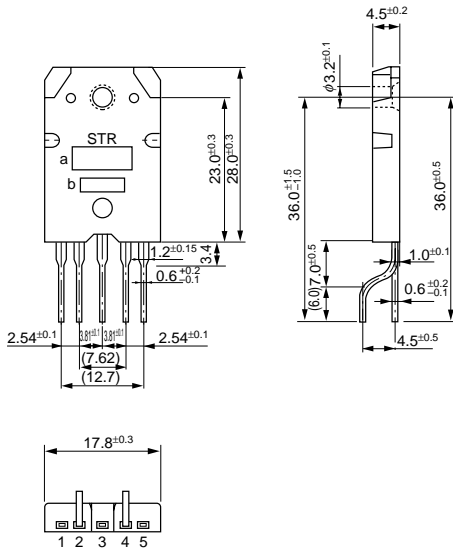

a. Part Number  
b. Lot Number

Forming No.501