

## SURFACE MOUNT SCHOTTKY BARRIER RECTIFIERS

**SS32--SS310**

### FEATURES

- Schottky barrier rectifier
- Guarding protection
- Low forward voltage
- Reverse energy tested
- High current capability
- Extremely low thermal resistance



### MECHANICAL DATA

- Case: SMC molded plastic body
- Polarity: Color band denotes cathode end
- Mounting position: ANY

### Maximum Ratings (@TA = 25°C unless otherwise specified)

Characteristic	Symbol	SS32	SS33	SS34	SS35	SS36	SS38	SS39	SS310	UNITS
Maximum repetitive peak reverse voltage	$V_{RRM}$	20	30	40	50	60	80	90	100	V
Maximum RMS voltage	$V_{RWS}$	14	21	28	35	42	56	63	70	V
Maximum DC blocking voltage	$V_{DC}$	20	30	40	50	60	80	90	100	V
Maximum average forward rectified current at $T_L=90^\circ\text{C}$	$I_{F(AV)}$	3.0								A
Peak forward surge current 8.3ms single half-sine-wave	$I_{FSM}$	100								A

### Thermal Characteristics

Characteristic	Symbol	SS32	SS33	SS34	SS35	SS36	SS38	SS39	SS310	UNITS
Maximum thermal resistance	R <sub>θ JL</sub>	17.0								°C/W
Operating temperature range	T <sub>J</sub>	-55----+125						-55----+150		°C
Storage temperature range	T <sub>STG</sub>	-55----+150								°C

### Electrical Characteristics (@TA = 25°C unless otherwise specified)

Characteristic	Symbol	SS32	SS33	SS34	SS35	SS36	SS38	SS39	SS310	UNITS
Maximum instantaneous forward voltage at I <sub>FM</sub> =3.0A	V <sub>F</sub>	0.50			0.75		0.85			V
Maximum DC reverse current T <sub>J</sub> =25℃ at rated DC blocking voltage TJ=125℃	I <sub>R</sub>	0.5								m A
		20			10		5.0			

## SURFACE MOUNT SCHOTTKY BARRIER RECTIFIERS

**SS32--SS310**

### PACKAGE OUTLINE DIMENSIONS

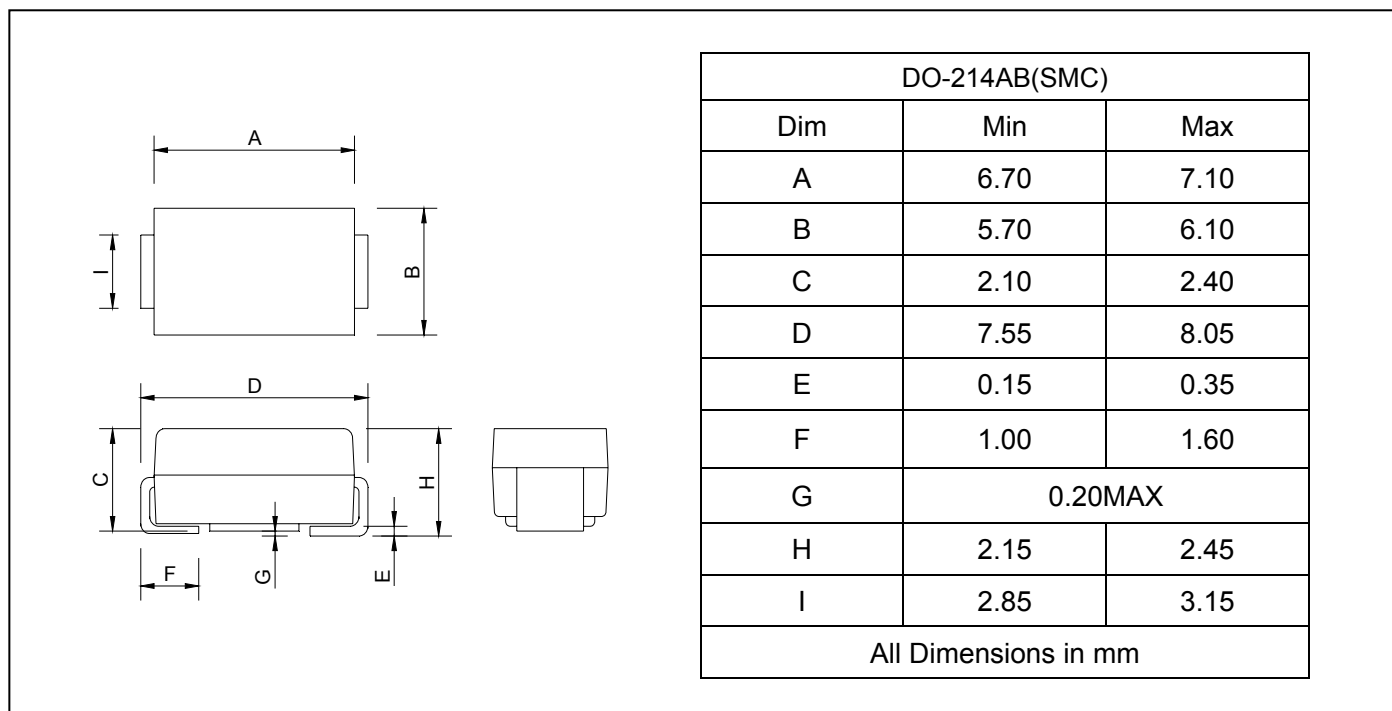

### SOLDERING FOOTPRINT

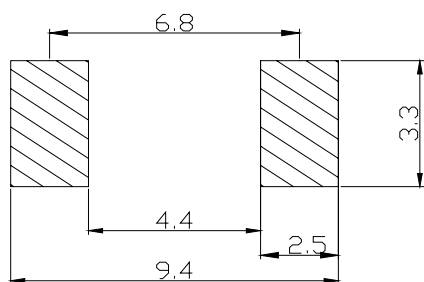

Unit : mm

### PACKAGE INFORMATION

Device	Package	Shipping
SS32--SS310	DO-214AB(SMC)	3000/Tape&Reel



## SURFACE MOUNT SCHOTTKY BARRIER RECTIFIERS

**SS32--SS310**

**FIG.1 – FORWARD DERATING CURVE**

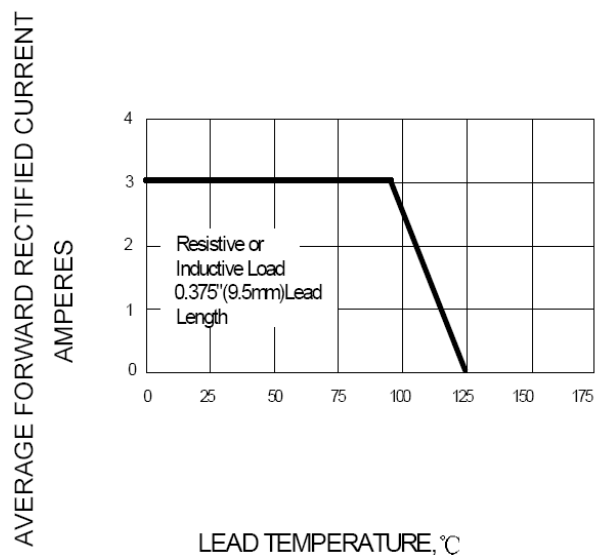

**FIG.2 – PEAK FORWARD SURGE CURRENT**

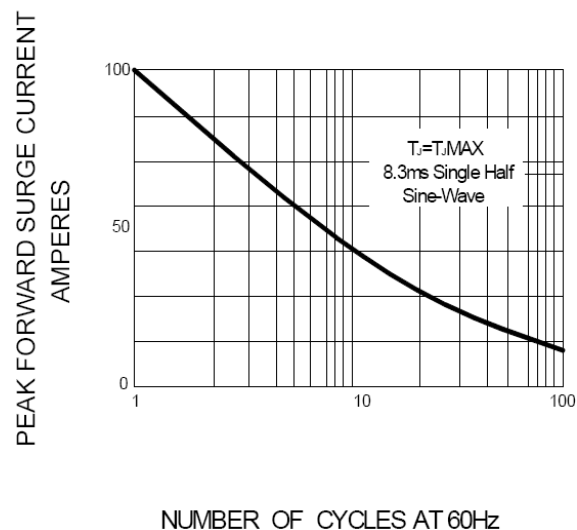

**FIG.3 – TYPICAL INSTANTANEOUS FORWARD  
CHARACTERISTICS**

