

Features

- 6mm Single Turn
- Cermet / Industrial / Sealed
- Top and side adjust types
(P.U, W.S most popular)

Style Code

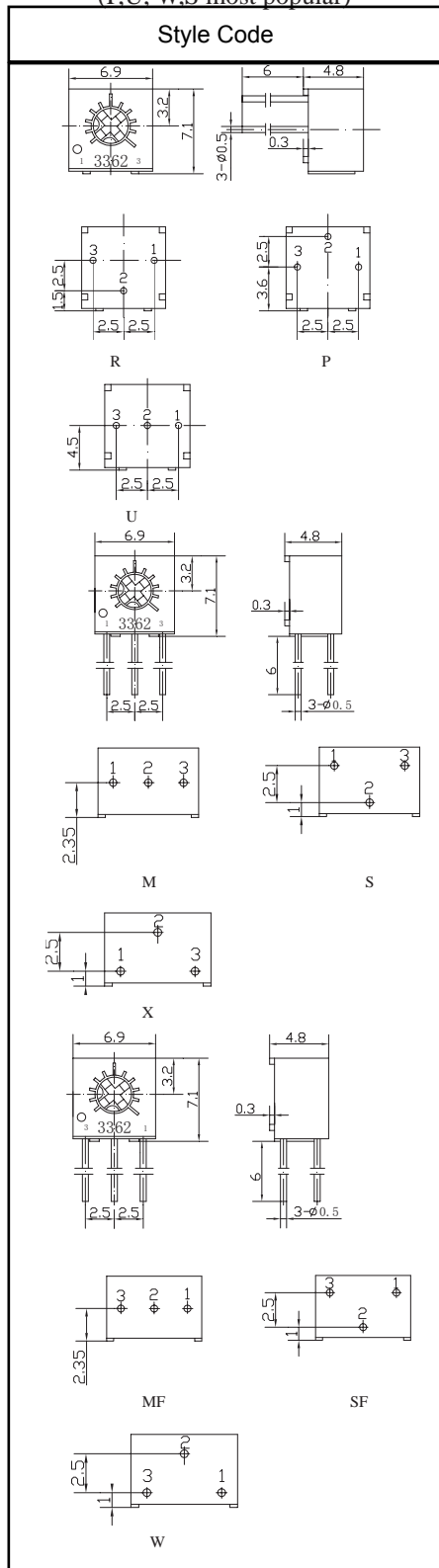

How to order

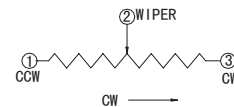
WIW3362—P—102
Model
Style
Resistance Code

Standard Resistance Table

Resistance (Ohms)	Resistance Code
100	101
200	201
500	501
1,000	102
2,000	202
5,000	502
10,000	103
20,000	203
25,000	253
50,000	503
100,000	104
200,000	204
250,000	254
500,000	504
1,000,000	105
2,000,000	205

Special resistance available

Detail Specification: Q/R Y260A-2000

Electrical Characteristics

Standard Resistance Range

100 to 2 Megohms

(see standard resistance table)

 Resistance Tolerance: $\pm 10\%$ std.

(tighter tolerance available)

Absolute Minimum Resistance:

1% or 2 ohms max.

(whichever is greater)

Contact Resistance Variation

3% or 3 ohms max.

(whichever is greater)

Adjustability

 Voltage $\pm 0.05\%$

 Resistance $\pm 0.15\%$

Resolution: Infinite

Insulation Resistance

500 vdc

1,000 Megohms min.

Dielectric Strength

101.3 kPa 500 vac

8.5 kPa 315 vac

 Adjustment Angle: 210° nom.

Environmental Characteristics

Power Rating (250 volts max.)

 0.5 watt (70°C), 0 watt (125°C)

Temperature Range

 -55°C to $+125^\circ\text{C}$

 Temperature Coefficient: $\pm 100\text{ppm}/^\circ\text{C}$

 Vibration: 98 m/s^2

 (1% Δ TR; 2% Δ VR)

 Shock: 390 m/s^2

 (1% Δ TR; 1% Δ VR)

Load Life

 1,000 hours 0.5 watt @ 70°C

 (3% Δ TR; 4% or 4 ohm)

Rotational Life: 200 cycles

 (3% Δ TR; 4% or 4 ohm)

Physical Characteristics

Mechanical Angle

 250° nom.

Torque

20 mN • m max.

Stop Strength

50 mN • m min.

Terminals

Solderable pins

Standard Packaging

50 pcs. per tube