

KCD3 101/N

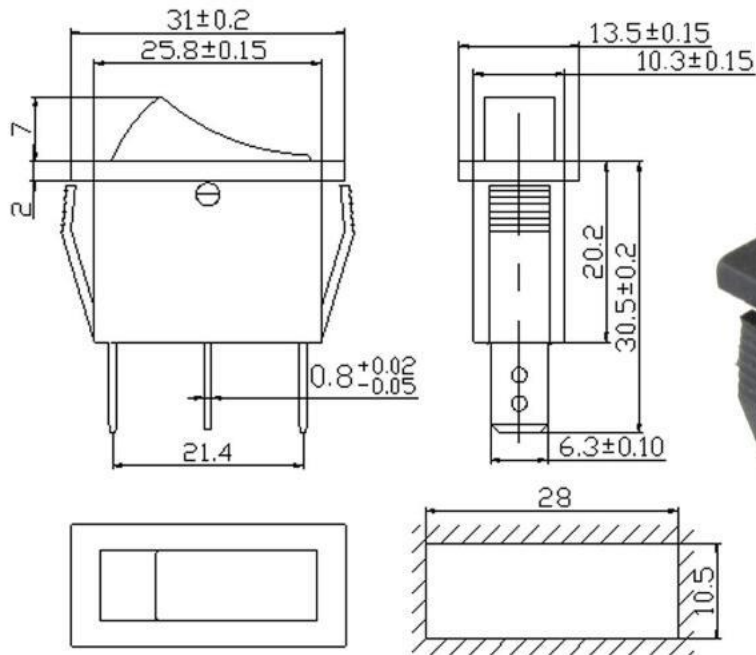

KCD3 16A 250V/20A 125V 3 Pin Red Button Light Rocker Switch
Rocker Power Switch

Specifications:

Model: KCD3

Colour:red

Weight:8g

Technical indicators:

Rated voltage: 16A 250V AC

Rated current: 20A 125V AC

KCD3-101 16 Amp Rocker Switch:

Daier KCD3-101 on off middle size rocker switch offer a high switching current in a compact design.

It is a snap-in mounted rocker switch with a high mechanical life in a rugged nylon 66 housing.

They have high quality for long life at heavy loads and industry-standard mounting dimensions.

This rocker switches can be used in a variety of applications, like water dispenser and extension socket and so on.

The KCD3-101 ON OFF rocker switch have one related product,pls check the detailed information as below:

KCD3-101	It is 2P,ON-OFF rocker switch without lamp
KCD3-111	It is 2P,OFF-momentary ON rocker switch without lamp

Pls check the datasheet below:

Housing:	Nylon 66	Button:	Nylon 66
Terminal:	Brass with sliver plated	Button color:	Black and red and white color,transparent color
Rating:	20A 125VAC/15A 250VAC	Housing color:	Standard black,white
Contact Configuration:	SPST	Switch Operation:	ON-OFF
Contact Resistance:	35mΩ max	Operating Temperature:	-25°C--+85°C
Insulation Resistance:	100mΩ min (500VDC)	Electrical Life:	≥ 10,000 Cycles
Dielectric strength:	1500VAC 1 minute	Mechanical Life:	≥ 100,000 Cycles
Certification:	CE, CQC, SGS	OEM or ODM:	Available